



# ERICE LINE

KARTA TECHNICZNA / TECHNICAL INFORMATION

## MZLC01

Wkładka do zamka 25/30  
Profile cylinder 25/30

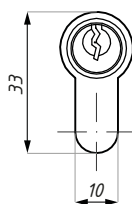
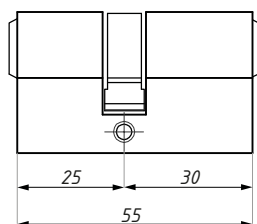

Kod / Code	Wykończenie / Finish
MZLC01 NS	satyna / satin
materiał: mosiądz	material: brass
<b>Uwaga: przy montażu zamków TGL40, TGL45, TGL60 oraz TGL70 na szkło powyżej 10 mm zalecamy zastosowanie wkładki TGLC03 SC</b>	<b>Note: when installing locks TGL40, TGL45, TGL60 and TGL70 on the glass thicker than 10 mm we recommend to use cylinder TGLC03 SC</b>

CDA Polska Sp. z o.o. Sp. k.

Ul. Robotnicza 60, 53-608 Wrocław





 [www.cdapolska.pl](http://www.cdapolska.pl)

 [www.oszkle.pl](http://www.oszkle.pl)

 [www.sklep.cdapolska.pl](http://www.sklep.cdapolska.pl)



 [biuro@cdapolska.pl](mailto:biuro@cdapolska.pl)

 Wrocław: 71 797 80 28

 Warszawa: 22 675 05 89

 Gdynia: 58 719 28 78