



# ERICE LINE

## KARTA TECHNICZNA / TECHNICAL INFORMATION

### TGLC01

Wkładka do zamka 21/27

Profile cylinder 21/27

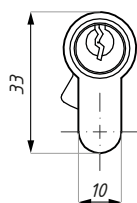
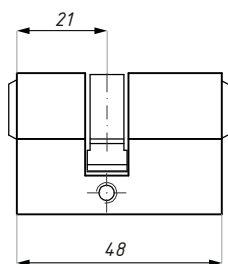

Kod / Code	Wykończenie / Finish
TGLC01 NA	anoda / anodised
materiał: mosiądz	material: brass
<b>Uwaga: wkładka do zastosowania z zamkami Erice Line montowanymi na szkle 8 mm.</b>	<b>Note: cylinder to use with locks Erice Line mounted on glass 8 mm.</b>
<b>Dla zamków TGL15 oraz TGL35 wkładkę można montować na szkle do grubości 10 mm.</b>	<b>For locks TGL15 and TGL35 cylinder can be mounted on glass thickness up to 10mm.</b>

CDA Polska Sp. z o.o. Sp. k.

Ul. Robotnicza 60, 53-608 Wrocław





 [www.cdapolska.pl](http://www.cdapolska.pl)

 [www.oszkle.pl](http://www.oszkle.pl)

 [www.sklep.cdapolska.pl](http://www.sklep.cdapolska.pl)



 [biuro@cdapolska.pl](mailto:biuro@cdapolska.pl)

 Wrocław: 71 797 80 28

 Warszawa: 22 675 05 89

 Gdynia: 58 719 28 78